

NOVAS

1300 Door Closers

1300 Door Closer

The Novas 1300 Hydraulic Door Closer comes with a slimline body, compact in size and with power adjustment for maximum flexibility. Applications include regular arm, parallel arm, top jamb, track arm and adjustable backcheck function.



Door Closer Selection Chart

Size	Regular Arm/Top Jamb			Parallel Arm/Track Arm			Door Weight Kgs
	Interior Door	Exterior Door		Interior Door	Exterior Door		
		Swing In	Swing Out		Swing In	Swing Out	
2	900	800	700	800	700	600	25-45
3	1050	900	800	900	800	700	40-60
4	1200	1050	900	1050	900	800	55-75

Maximum door width dimension in mm

Door Closer Applications

Mounting Details

<p>Regular Arm Installation Closer is fixed to the pull (hinge) side of the door.</p>	<p>Parallel Arm Installation Closer is fixed to the push (opposite to hinge) side of the door.</p>
<p>Top Jamb Installation Closer is fixed to the Top Jamb on the push (opposite to hinge) side of the door.</p>	<p>Regular Track Arm Installation Closer is fixed to the pull (hinge) side of the door.</p>
<p>Top Jamb Track Arm Installation Closer is fixed to the Top Jamb on the pull (hinge) side of the door.</p>	

NOVAS

1300 Door Closers

Technical Data – Limiting Dimensions

Regular Arm

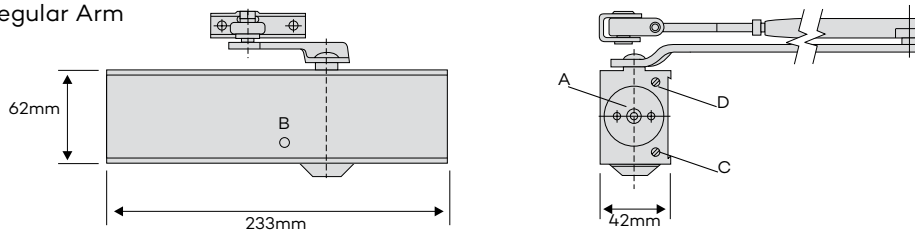

Track Arm

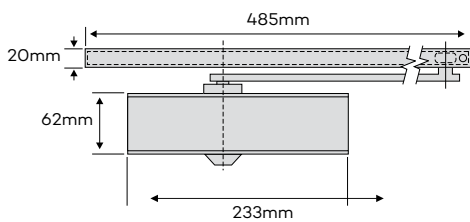

Legend

- A. Power Adjustment
- B. Backcheck
- C. Closing Speed
- D. Latching Speed

Note:

- Specification of track arm and parallel arm applications should consider the single strength reduction in power.
- The 1300 Door Closer is not available with delayed action function.

A. Power Adjustment

Simple adjustment by rotation of a captive screw adjusts the size of the closer to the desired strength. 1300VBC (size 2-4), 1300VTR (size 1-3).

B. Backcheck

Adjustable backcheck provides cushioning effect on opening to give protection to the door and fittings.

C. Closing Speed

Captive valve is conveniently located on the end of the door closer to control the closing speed.

D. Latching Speed

A separate adjustment valve to accelerate or decelerate the door to ensure positive latching.

Adjustment Details

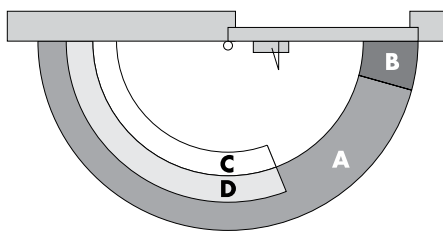

A	Closing Range	15 ° - 180 °
B	Latching Range	0° - 15 °
C	Backcheck Range	70 ° - 180 °
D	Hold Open Range	70 ° - 180 °

Mechanism & Case

High Pressure diecast aluminium body, rack and pinion hydraulic controlled piston door closer. Reversible for left-hand and right-hand doors.

Ordering Procedure

Cat No.	Description	Finish
1300VBC	Doorcloser Adj (2-4)	SIL/SSS/PSS
1300VTRB	Track Arm Door Closer (1-3)	SIL/SSS/PSS

Accessories to suit 1300 Closer

1300 - 10	Hold Arm Open to suit	SIL
1300 - 11	Track Arm Assembly	SIL
1300 - 20	Drop Plate to suit	SIL
1300 - 30	Parallel Arm Bracket	SIL
1300 - 40	Cover	SSS/PSS

Finish

SIL	Silver
SSS	Satin Stainless Steel
PSS	Polished Stainless Steel

Fire Rating

FIRE DOORS

Approved on fire door assemblies up to 2 hours in accordance with Australian Standard AS 1905 - Part 1 - Fire resistant door sets.



Fire Rated

NOVAS

Novas Door Controls

Novas Hydraulic door closers are designed to suit various residential and commercial applications. By definition, door closers are used to close hinged leaf doors after they have been manually opened. The smooth closing operation is controlled by the adjustable hydraulic rack and pinion mechanism.

In choosing a closer style for a particular application consideration should be given to the type of door being controlled, frame condition, aesthetic and the control features required by the end user.

The size and weight of the door is the main consideration in selecting a closer of the correct strength. Recommended door widths for each closer assume normal operating conditions. If a door is of exceptional height, weight, special construction, or if air pressure differentials exist, a more powerful closer should be considered.

A door closer effectively increases the loading on door hinges and their rate of wear. It is recommended that any door fitted with a door closer should use three or more Novas Ball Bearing/Sintered Bearing Hinges.

It is essential that the door be clear in the door frame and when fitted with a lock the latch bolt must engage freely with the strike.

Floor or wall mounted doorstops should be fitted to prevent possible damage to the door frame and fitted hardware.

Services

Novas Architectural offers a fully comprehensive (free of charge) specification/door scheduling service to meet Project requirements. Door schedules are prepared by our scheduling team who are all design and/or industry trained professionals. Please contact your local Novas Architectural representative for assistance.

Guarantee

Novas Architectural guarantee all their products against defects in workmanship and materials subject to inspection and confirmation of fair wear and tear within the normal working life of the product.

Novas Architectural assumes no liability for:

1. Improper installation or failure to follow fitting instructions.
2. Product failure due to improper maintenance or unfair wear and tear.
3. Indirect or consequential loss or damage.
4. Cost of removal and/or replacement.
5. Cost of freight and/or travelling expenses.
6. Some plated finishes are classified as soft finishes. Deterioration is possible under some climatic conditions and cannot be unconditionally guaranteed.

Consult your local Novas Architectural Representative or Agent for advice on all finishes.